

A11709091 © Miami MLS© 2024

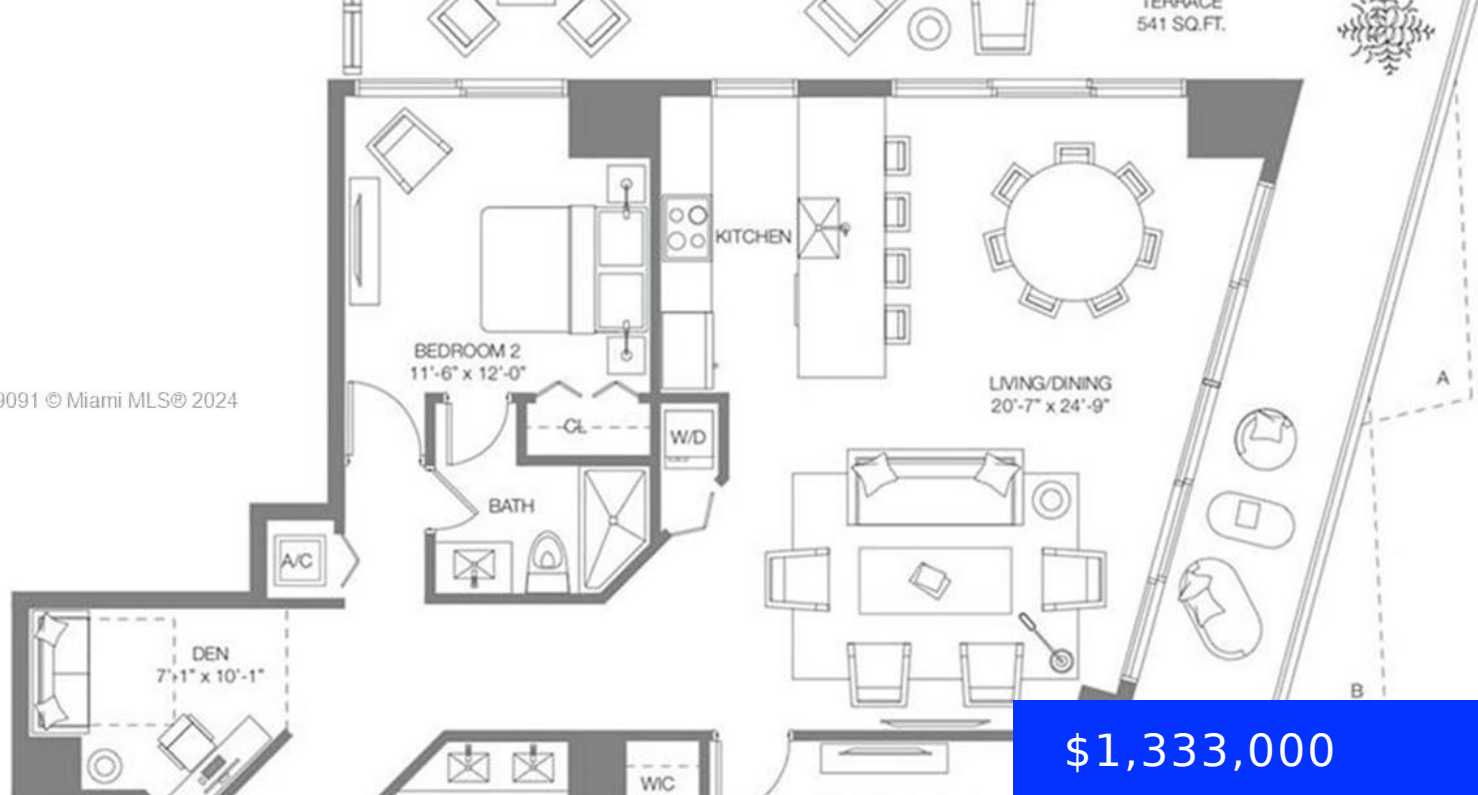

1300 MIAMI AVE, MIAMI, FL, 33130

<https://ritterproperties.com>

Unobstructed view of the ocean, bay and the city. Best line and view from this corner unit that allows for a daily speechless sunrise and sunset. Simply unique. The SLS Brickell Hotel offers luxurious amenities, full service spa and state of the art gym for unit residents. It has Bosch and Subzero appliances, high ceilings [...]

\$1,333,000

- 2 beds
- 2 baths
- Residential
- Condominium
- Active
- 1279 sq ft

Basics



Date added: Added 4 months ago

Type: Residential

Bedrooms: 2 beds

Half baths: 0 half baths

Area: 1279 sq ft

SubdivisionName: 1300 S MIAMI AVENUE CONDO

GarageSpaces: 1

UnitNumber: 4601

EntryLevel: 46

Category: Condominium

Status: Active

Bathrooms: 2 baths

Total rooms: 5

Lot size, sq ft: 0 sq ft

ListOfficeName: Get More Offers

View: Bay, Ocean View, Skyline

ListAOR: Miami Association of REALTORS®

MLS ID: A11709091

Rooms

Room type	Dimensions	Area	Length	Width
Kitchen	9x12	108	9	12
LivingRoom	25x21	525	25	21
SecondBedroom	12x12	144	12	12
PrimaryBedroom	12x14	168	12	14
Den	7x10	70	7	10

Building Details



Cooling features: Central Air

ArchitecturalStyle: Corner Unit, High Rise

Building Name: SLS Brickell

Heating: Central

Year built: 2016

NewConstructionYN: No

Exterior material: CBS Construction

Parking: Assigned, Valet

Amenities & Features

Features: Built-in Features, Closet Cabinetry, Den/Library/Office, Fire Sprinklers, Utility Room/Laundry, Walk-In Closet(s)

Amenities: Dishwasher, Dryer, Electric Water Heater, Microwave, Refrigerator, Washer

Waterfront available: No

AttachedGarageYN: No

PoolPrivateYN: Yes

Security Features: Fire Sprinklers, Lobby Secured

ExteriorFeatures: Open Balcony

GarageYN: Yes

CoolingYN: Yes

FireplaceYN: No

