

## RESIDENCE B3

3 BEDROOMS / 4.5 BATHROOMS

INTERIOR	3,198 SF	297.10 M <sup>2</sup>
TERRACE	913 SF	84.82 M <sup>2</sup>
TOTAL	4,111 SF	381.92 M <sup>2</sup>

\* Floor Plan shown on 10th Floor, add or subtract 59 SF / 5.5 M<sup>2</sup> per level

Prive offers 160 graciously appointed residences in two dramatically angled, 16-story buildings. Featuring flow-through layouts with soaring, ten-foot ceilings, each Prive residence offers dramatic views of both the Atlantic Ocean and the Intracoastal Waterway through expansive floor-to-ceiling windows.

Private elevator foyers lead to spacious, well-proportioned spaces ranging from 2,585 to over 9,000 square feet. Exceptional fixtures and finishes include European kitchens and baths, plus elaborate summer kitchens for outdoor entertaining on deep, private terraces.

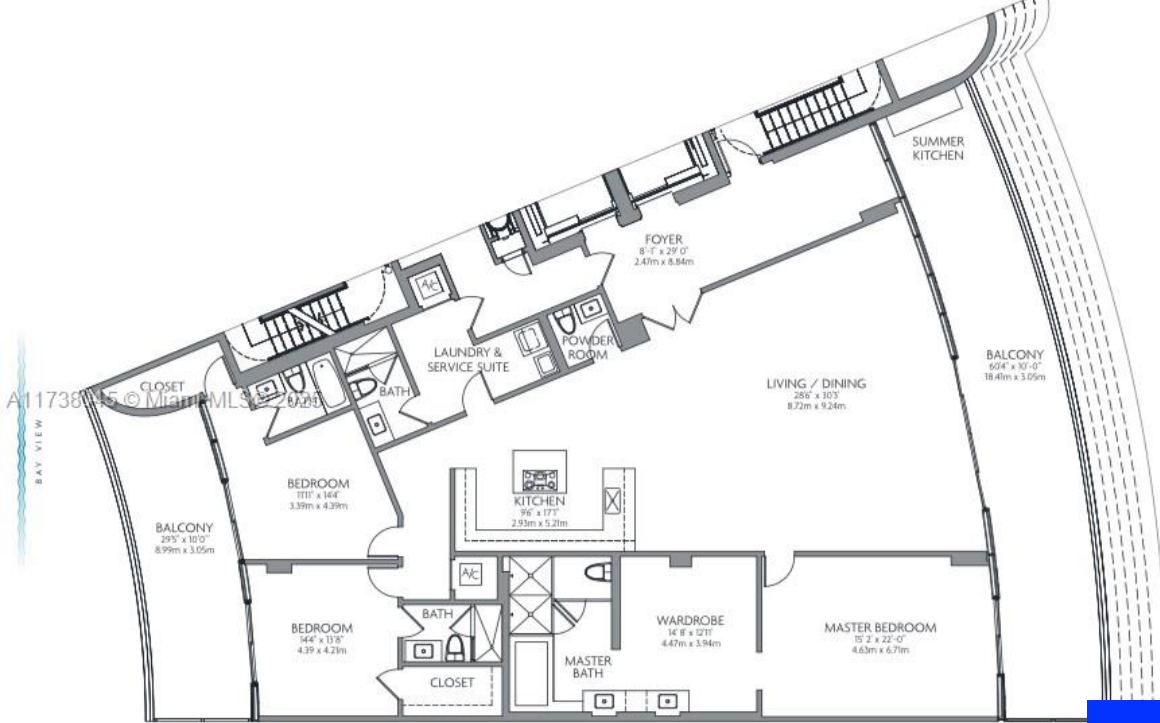

**\$19,500**

## 5500 ISLAND ESTATES DR, AVENTURA, FL, 33160

<https://ritterproperties.com>

Nested at PRIVE Condominium on PRIVE Island, where privacy & elegance come together. 504N is a fantastic flow-through unit with private elevators & foyer, 2 bedrooms/2.5 bath, 2 balconies, 1 parking space, Unobstructed intracoastal, ocean and city views.. Exclusive lifestyle amenities include 2 outdoor heated pools, tennis courts, wine & cigar rooms, library & party rooms, Spa, [...]

- 2 beds
- 2 baths
- Residential Lease
- Condominium
- Active
- 2339 sq ft



---

## Basics

**Date added:** Added 3 weeks ago

**Type:** Residential Lease

**Bedrooms:** 2 beds

**Half baths:** 1 half bath

**Lot size, sq ft:** 0 sq ft

**ListOfficeName:** London Foster Realty

**View:** Intracoastal View, Ocean, Tennis Court View

**ListAOR:** Miami Association of REALTORS®

**MLS ID:** A11738045

**Category:** Condominium

**Status:** Active

**Bathrooms:** 2 baths

**Area:** 2339 sq ft

**SubdivisionName:** PRIVE CONDO

**GarageSpaces:** 1

**UnitNumber:** 504

**EntryLevel:** 5

---

## Building Details

**Cooling features:** Other

**ArchitecturalStyle:** First Floor Entry

**Building Name:** PRIVE CONDO

**Roof:** Concrete

**Parking:** Limited # Of Vehicle, No Rv/Boats, No Trucks/Trailers, Valet

**Year built:** 2017

**NewConstructionYN:** No

**Exterior material:** Aluminum Siding

**Heating:** Other

---

## Amenities & Features

**Security Features:** Gated with Guard, Lobby Attended

**CommunityFeatures:** Boating, Pool, Tennis Court(s), Game Room, Gated Community, Management On Site, Spa/Hot Tub

**Waterfront available:** Yes

**AttachedGarageYN:** No

**PoolPrivateYN:** No

**Spa Features:** Community

**PoolFeatures:** Above Ground

**GarageYN:** Yes

**CoolingYN:** Yes

**FireplaceYN:** No

